

Wood County Solid Waste Management District's

Recycling Container Loan Program!

A great way to increase recycling at your next event or gathering!!



The ClearStream Recycling Containers you see at this event are available for loan!

In order to secure your date and arrange for pickup, arrangements must be made with our office no later than one week prior to your event. We recommend contacting us sooner due to the popularity of this program.

We will not charge you a fee to borrow the containers and we will provide you with enough bags for your event, however, you are responsible for transporting the recyclables to a proper recycling facility and for picking up/returning the containers.

Please contact our office at 419-354-9297 for more information.

ClearStream Use: Tips & Instructions

1. When plotting out the areas, include where ClearStreams and other garbage units will be placed. **ClearStreams should always be placed next to normal garbage units.**
2. Make sure they are located in visible and appropriate areas. Place near food vendors along with sporadically throughout the event.
3. Train Volunteers. Teach them to properly secure bags and attach lids to the frame. Make sure the supervisors are trained on how to get them on/off the frames and they in turn will train their support staff. Please see diagram below for instructions, or visit the Clear Stream website at www.clearstreamrecycling.com.
4. Make sure volunteers are collecting and replacing bags when they are 2/3 full.
5. Keep the lids clean by wiping them down with rags as necessary.
6. You are responsible for transporting the recyclables to a proper recycling facility.

Recycling...The Clear Choice® BAG LOCK, As Easy As 1 - 2 - 3!

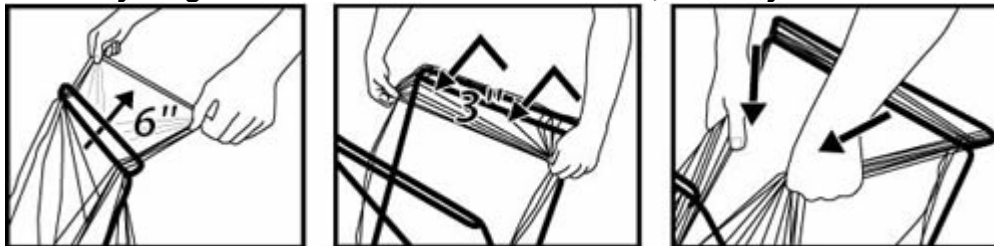

1. Through the Loop 6"

2. Over the Loop 3"

3. Pull sides down & in!

Thank you for recycling at your event!

Please contact the Wood County Solid Waste District if you have questions.

419-354-9297 • www.recyclewoodcounty.org

**This agency operates under the direction of the Wood County Board of Commissioners
Doris I. Herringshaw, Ed.D. • Craig LaHote • Dr. Theodore H. Bowlus**